



*Finished Size: approx. Skull A = 3.3cm x 3.2cm and Skull B = 3.7cm x 3.2cm (without the clip finding)

*Tools: Scissors, Ruler, Toothpick, Beading Glue, Beading Needles

Materials

Delica Beads size 11
(100g = approx 20,000 pcs)

DB0010 : 178 pcs

DB0214 : 46 pcs

DB1451 : 517 pcs

Nylon thread (white)

Clip Finding : 1 pc



See the pattern. Use 2.4m x 2pcs of nylon threads and string a needle. Leave 80cm thread tail and string a stopper bead. First make Skull A. Start weaving Delica Beads of the ladder stitching part (1-13) and brick stitching part (14-285) by using the 1.6m thread. Finish the thread tail. Remove the stopper bead and weave the part (286-366) by using the 80cm thread tail. Finish the thread tail. Make Skull B as the pattern shows.

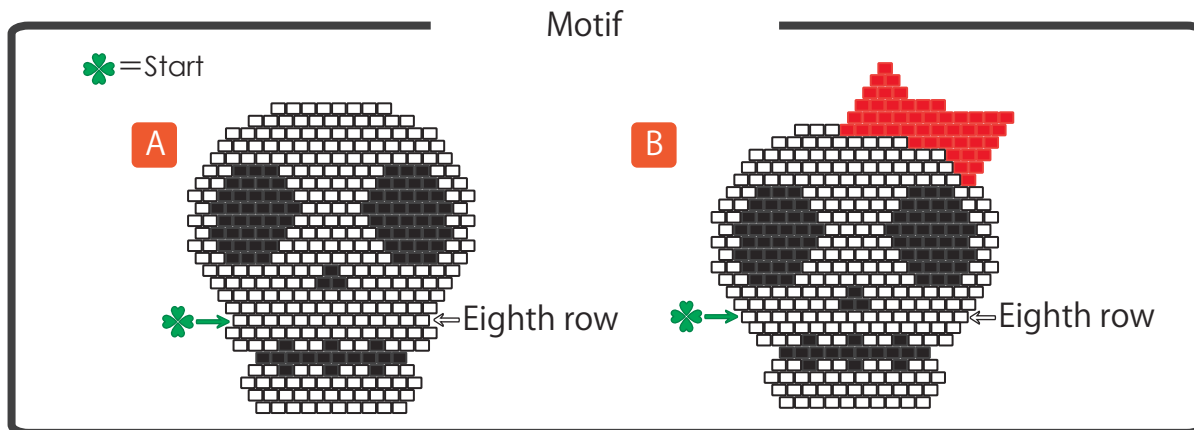

A

DB-1451

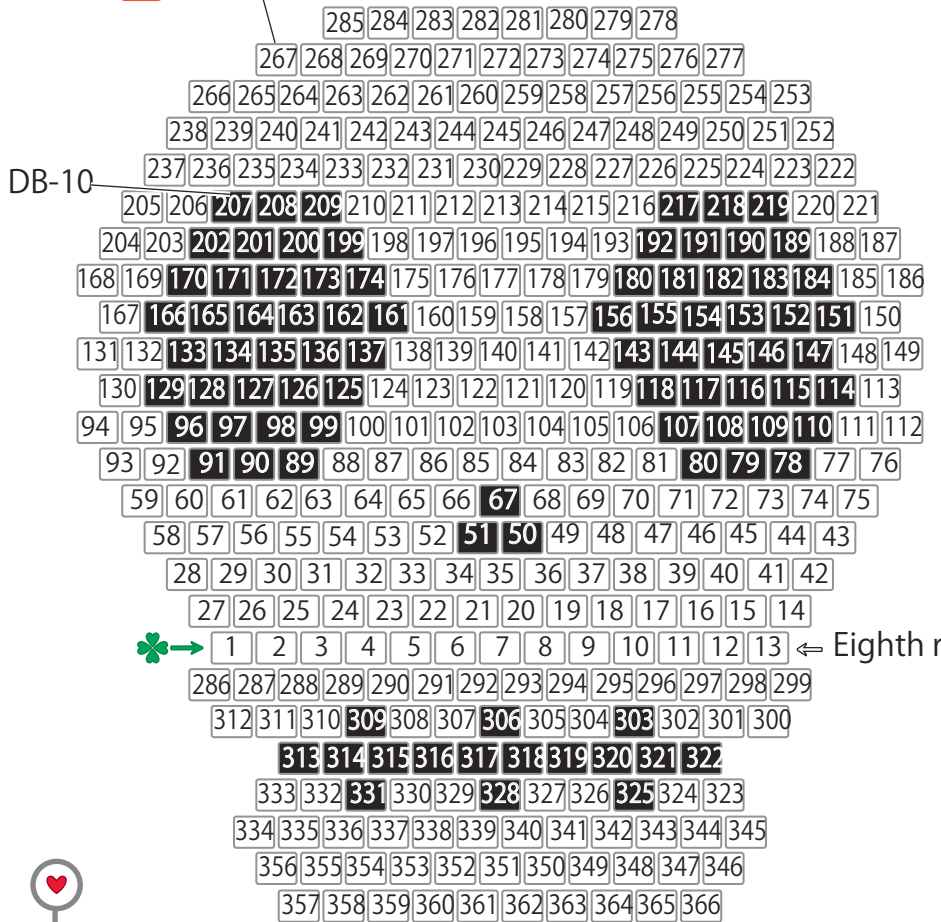

← Eighth row

《♥How to thread》

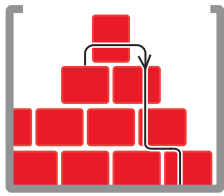

DB-214

B

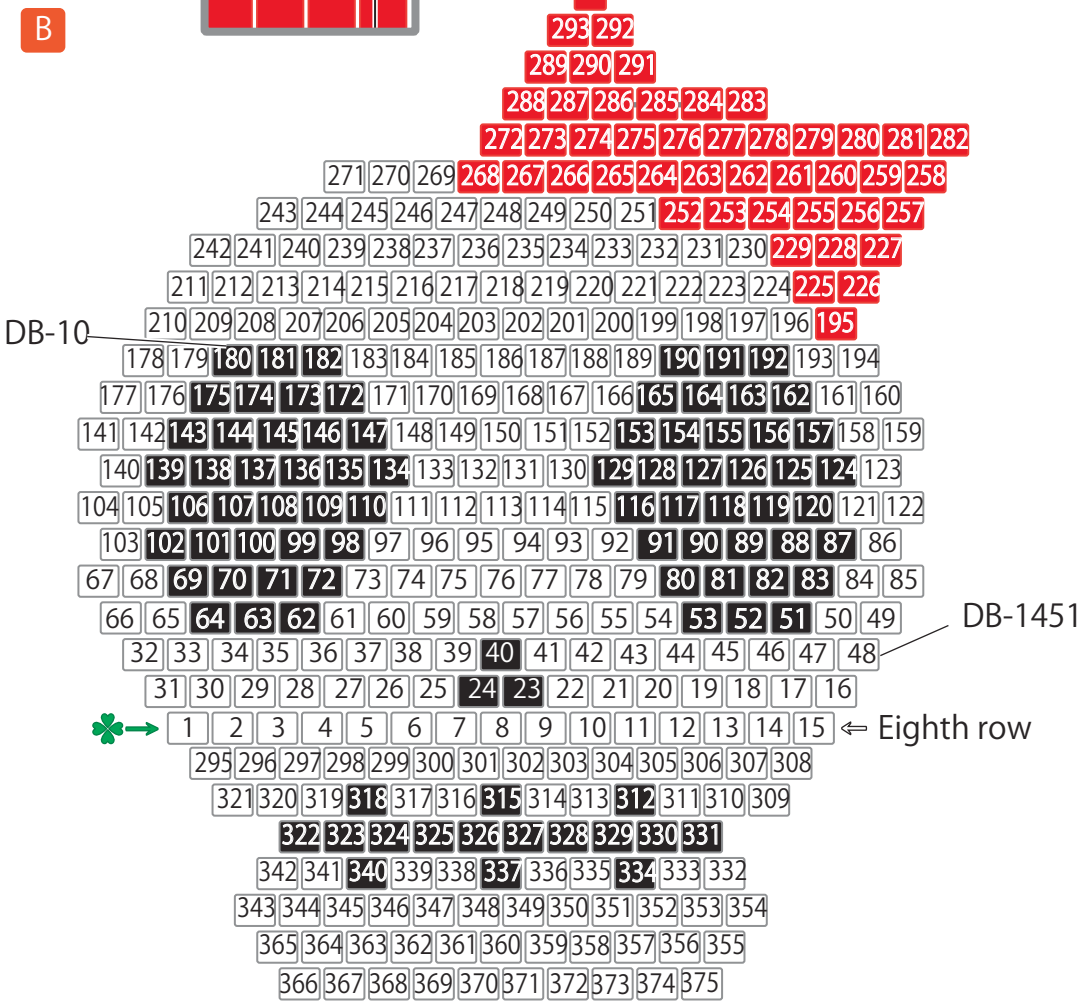

← Eighth row

2) Put beading glue on the middle of clip finding by toothpick, paste the beaded Halloween Skulls on the clips and dry them.

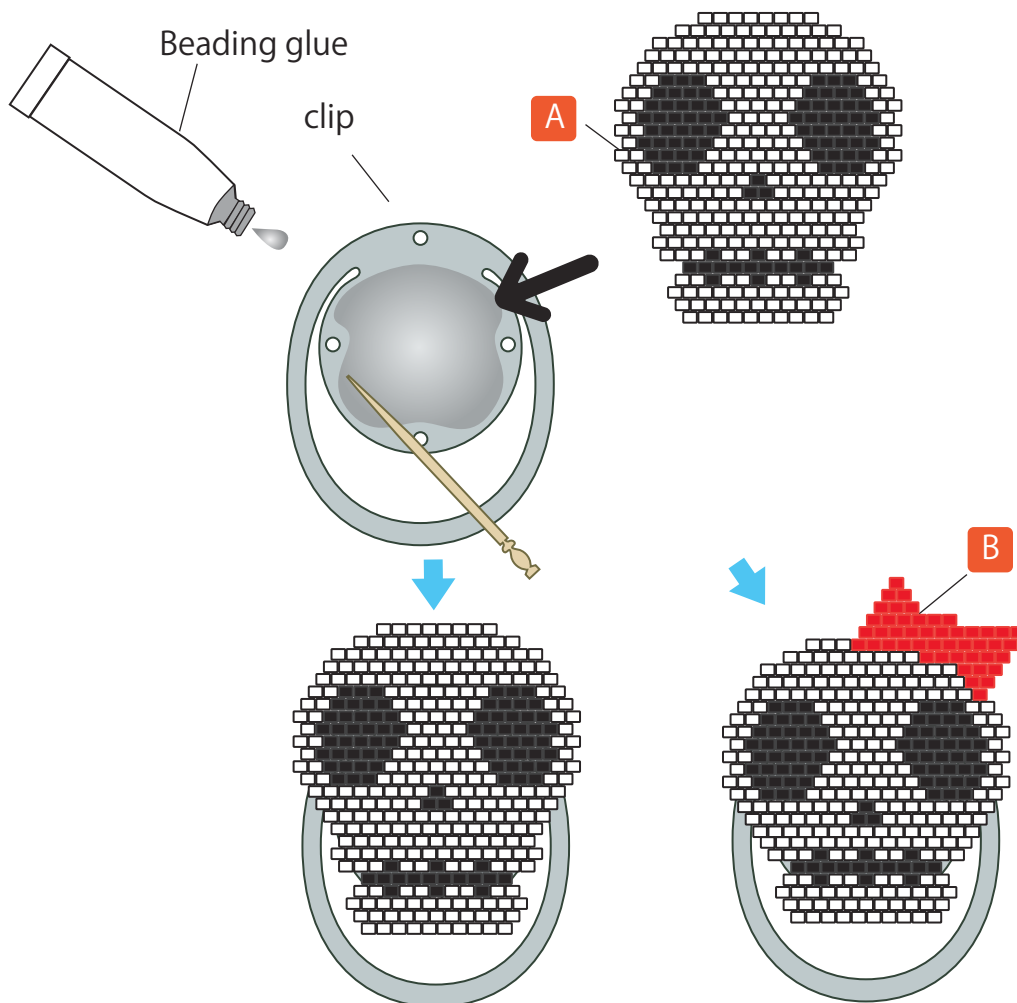

Happy Halloween!