

# Sharp Triangle Beads instruction

## Sharp Triangle Beads Braid Necklace

MIYUKI Co., Ltd.  
mail: e-mail@miyuki-beads.co.jp  
web: www.miyuki-beads.co.jp/english  
Note: Re-sell this instruction is prohibited



 **MIYUKI CO., LTD.**  
Sharp Triangle Beads Braid Necklace

Finished size...About 50cm (1.62 ft.)

Tools...Scissors • Ruler • Tape • Round nose pliers

- 1) Cut six 1.6m (5.19ft) lengths of beading thread, then thread a needle with single thread. Tape the thread 10cm (3.94 in.) from the end. Pass the threads through the beads to make 6 beaded strings as in the picture.

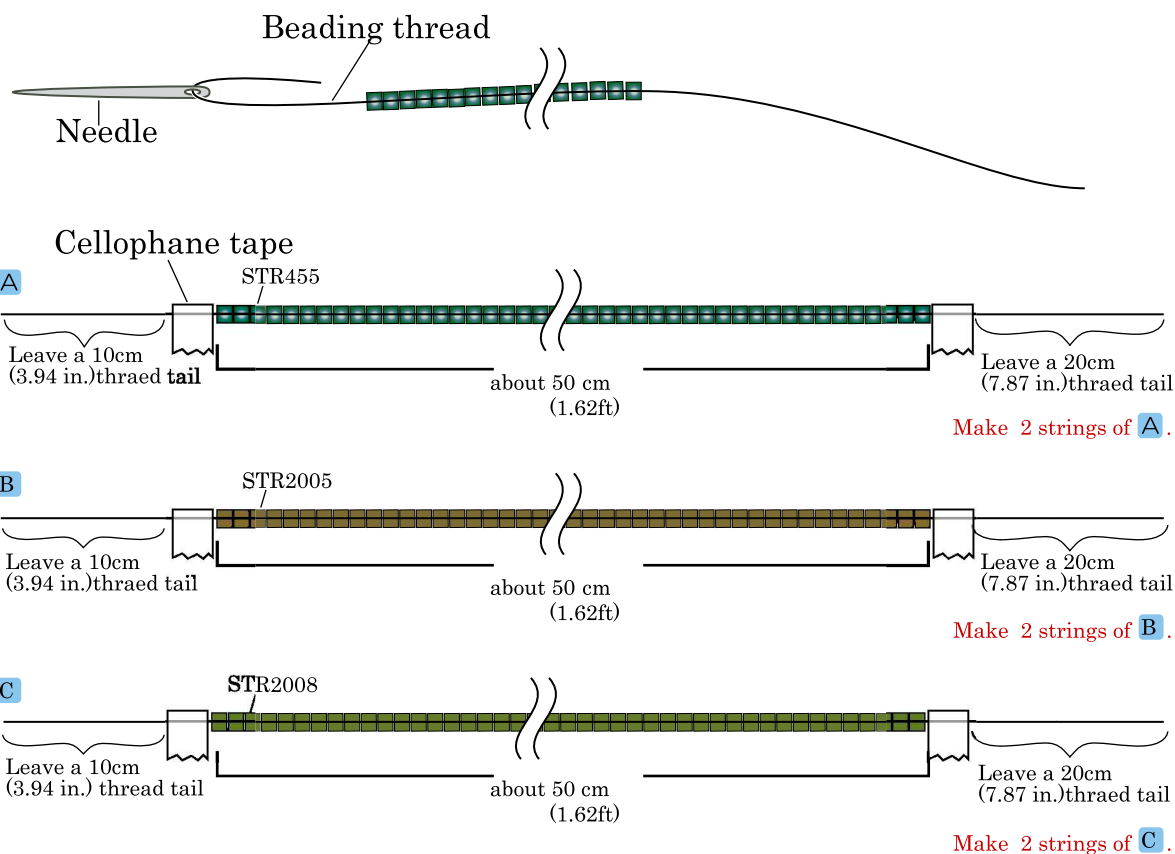

# Sharp Triangle Beads instruction

MIYUKI Co., Ltd.  
mail: e-mail@miyuki-beads.co.jp  
web: www.miyuki-beads.co.jp/english  
Note: Re-sell this instruction is prohibited

## Sharp Triangle Beads Braid Necklace

- 2) Remove the tape from the thread tails at one end (10cm tails) of six strings. Secure them with an over hand knot.

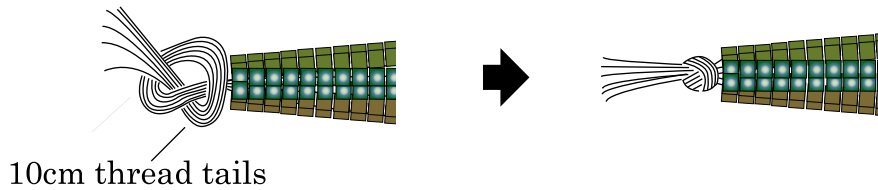

- 3) Tape the thread ends as in the picture. Separate the beaded strings into three groups, then braid them. (If it is tight to braid strings along the way, slide tape of each string at 1) to the thread ends little by little.)

Tape the thread ends to the table.

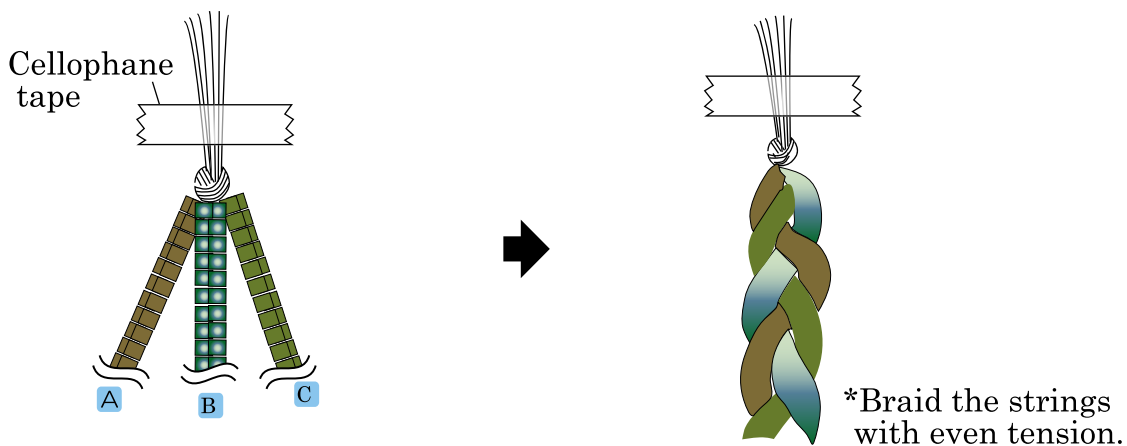

- 4) Make 40cm (1.3 ft.) of braided strings, then take some beads off from the thread tails to align the end of the braiding. Remove tape from each thread ends, then secure all of them. Glue the knots on both ends and cut off excess thread ends.

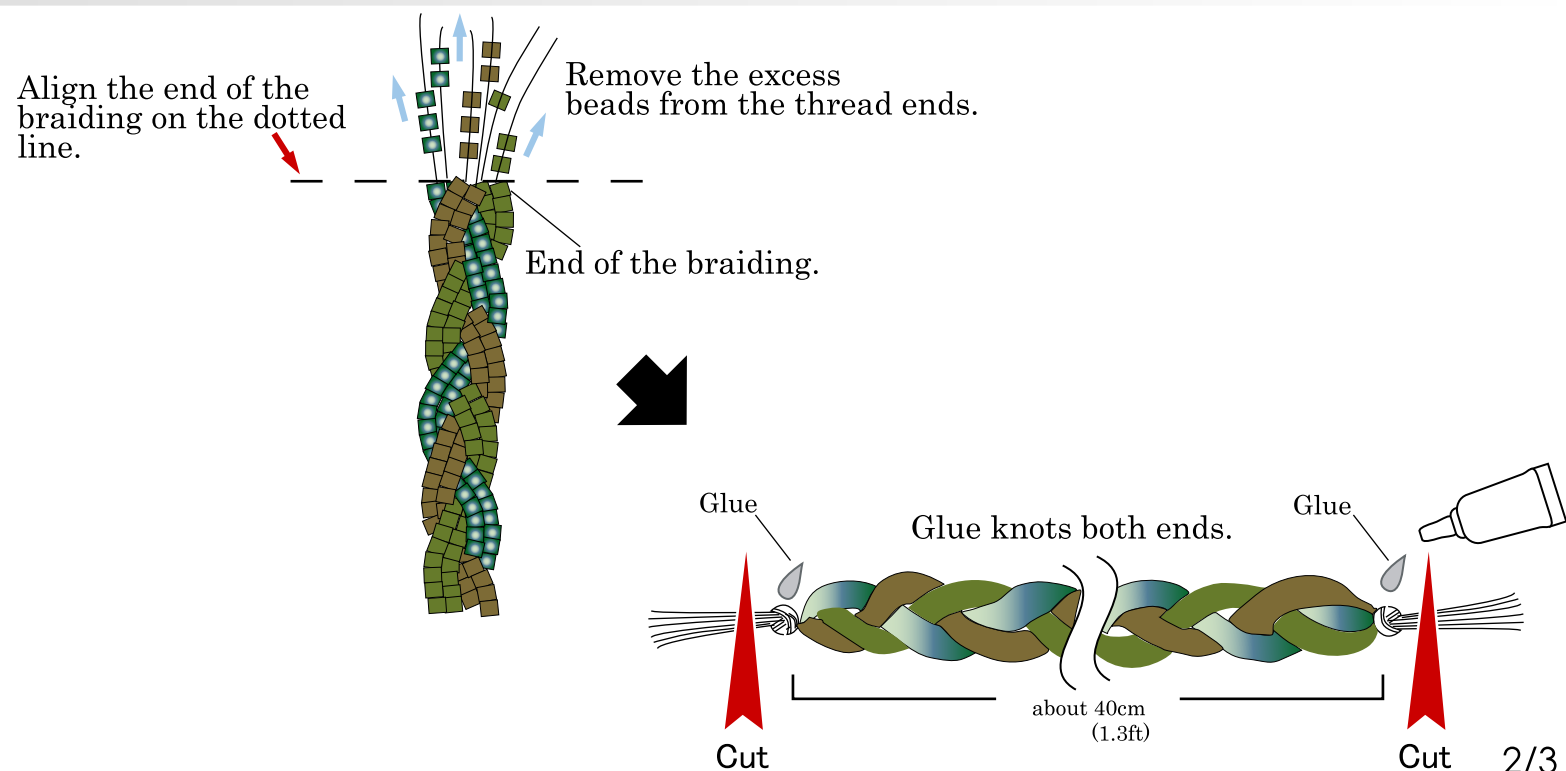

# Sharp Triangle Beads instruction

## Sharp Triangle Beads Braid Necklace

MIYUKI Co., Ltd.  
mail: e-mail@miyuki-beads.co.jp  
web: www.miyuki-beads.co.jp/english  
Note: Re-sell this instruction is prohibited

- 5) Catch the knot in eye pin, then string the cap on the eye pin as in the picture.  
Roll the eye pin into double loop. Flatten the cap with fingers.

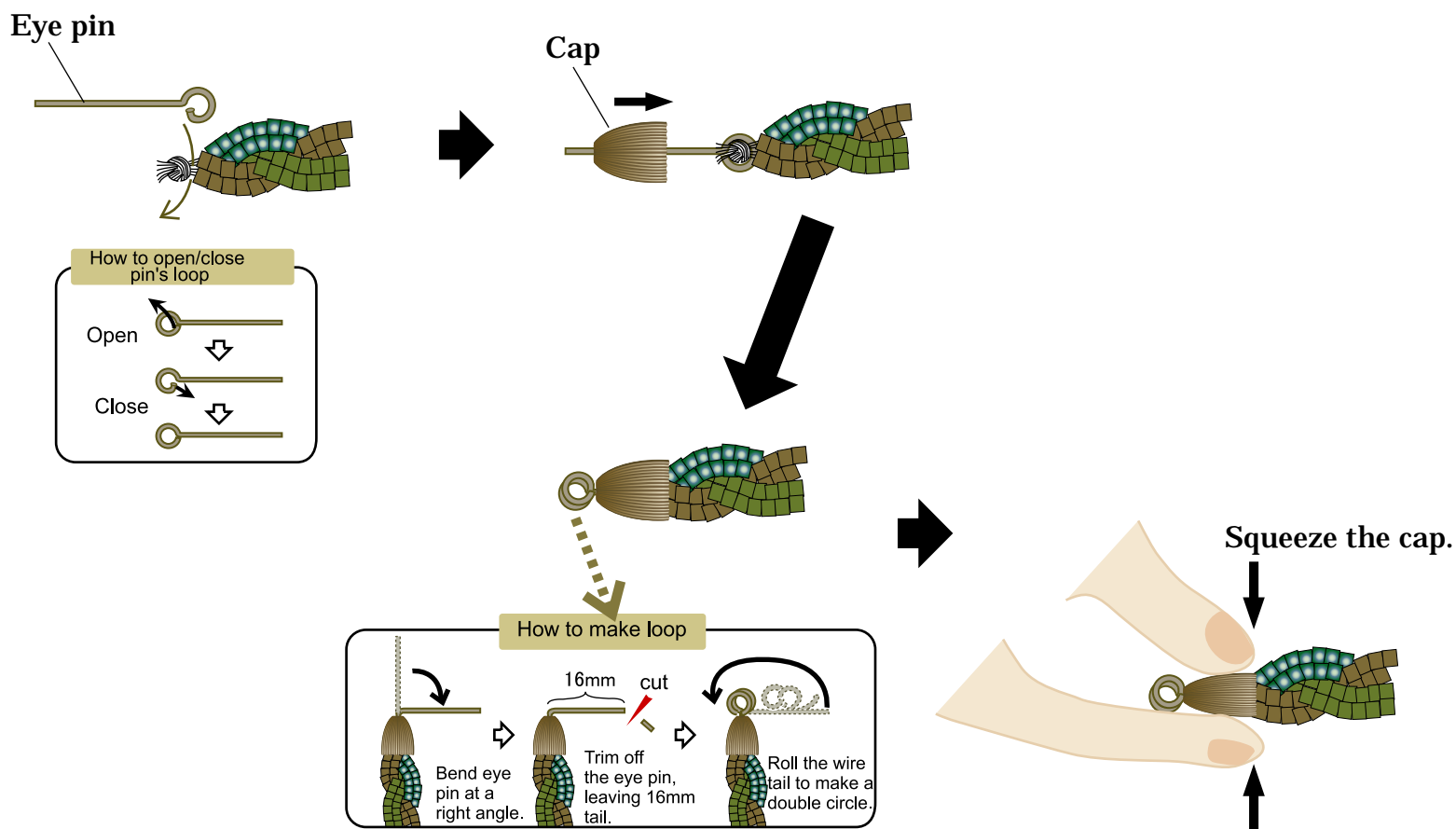

- 6) Attach the clasp and leaf shaped charms (It's your choice! ).

